

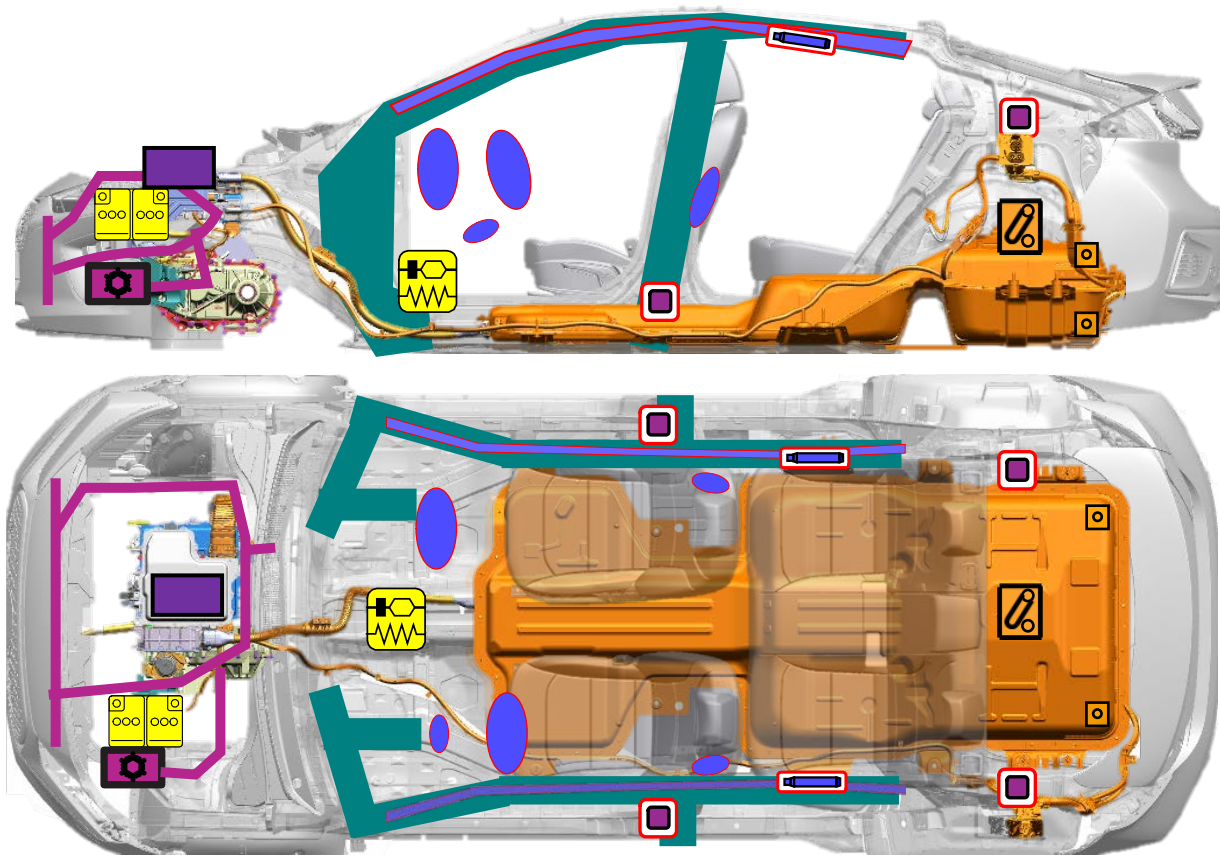











## Vehicle Identification/Recognition



## Accessing Vehicle



	Supplemental Restraint System Control Module (SRSCM)		Airbag		Airbag Gas Inflators
	High voltage cable		12V Battery		Air-conditioning line
	High Voltage Disconnect		OBC (On – Board Charger)		Ultra-High Strength Steel
	High Voltage Battery		Air-conditioning component		Seat belt pretensioner

## Disabling Vehicle

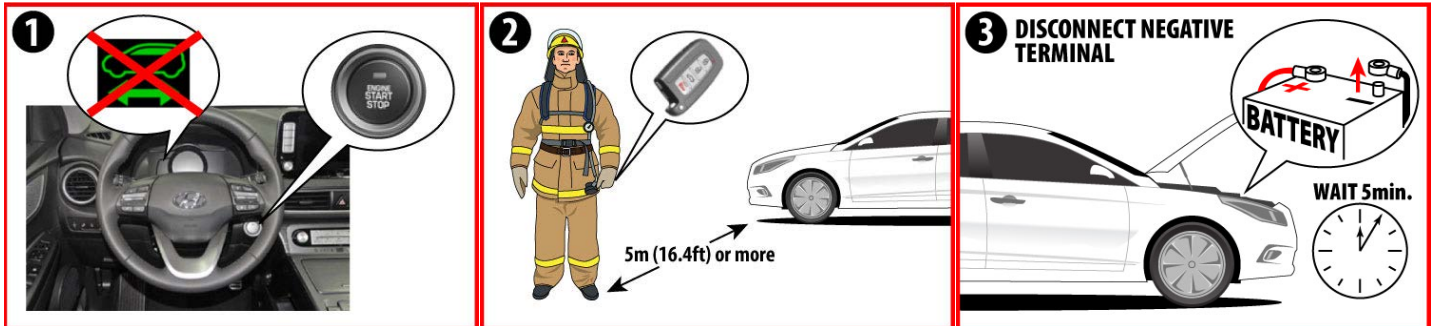

**OR**

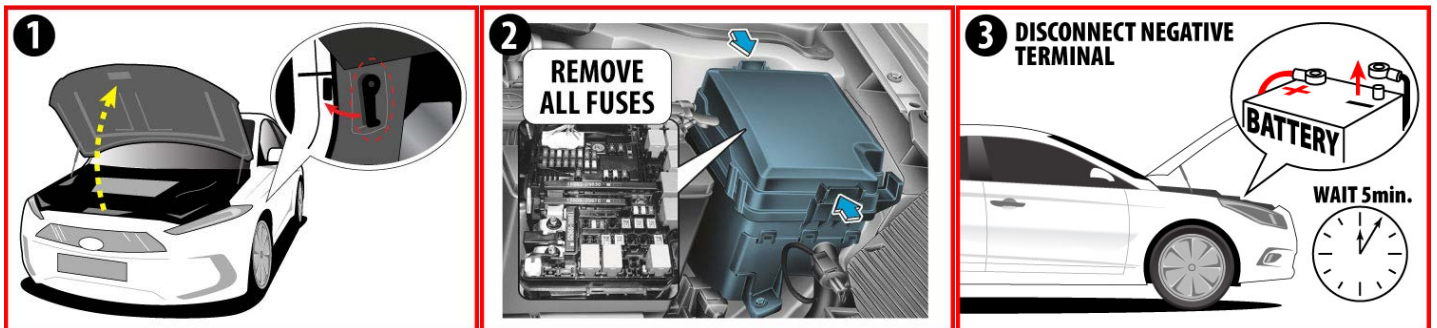

**OR**

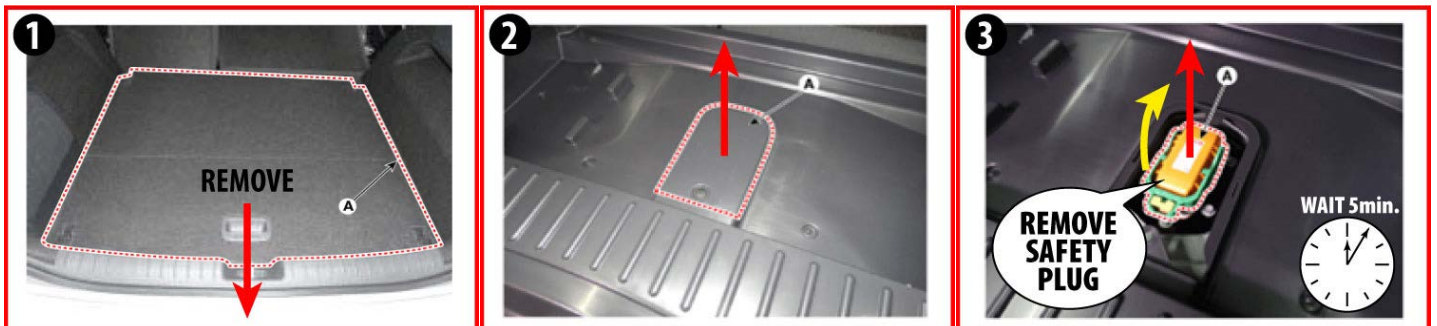

## Towing Information

*Tow the vehicle using a flat bed or using wheel dollies. Never tow the vehicle with the front or rear wheels on the ground*



For further information, please refer to the Emergency Response Guide (ERG).

Applicable to IONIQ Electric vehicles first sold in the United States.	ID. No.	Version No.	Page
	KMH-AE EV	01.2021.09	2 of 2